

Si photodiode S1087/S1133 series

Ceramic package photodiode with low dark current

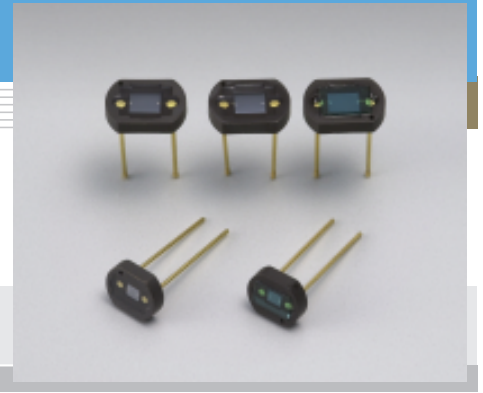

S1087/S1133 series are ceramic package photodiodes that offer low dark current. Ceramic package used is light-impervious, so no stray light can reach the active area from the side or backside. This allows reliable optical measurements in the visible to near infrared range, over a wide dynamic range from low light levels to high light levels.

Features

- S1087, S1133 : For visible range
- S1087-01, S1133-01: For visible to IR range
- S1133-14 : For visible to near IR range

Applications

- Exposure meter
- Illuminometer
- Camera auto exposure
- Stroboscope light control
- Copier
- Display light control
- Optical switch

General ratings / Absolute maximum ratings

Type No.	Dimensional outline/ Window material *	Active area size (mm)	Effective active area (mm ²)	Absolute maximum ratings		
				Reverse voltage V _R Max. (V)	Operating temperature T _{opr} (°C)	Storage temperature T _{stg} (°C)
S1087	①/V	1.3 × 1.3	1.6	10	-10 to +60	-20 to +70
S1087-01	②/R					
S1133	③/V	2.4 × 2.8	6.6			
S1133-01	④/R					
S1133-14						

* Window material R: resin coating, V: visual-compensation filter

Electrical and optical characteristics (Typ. T_a=25 °C, unless otherwise noted)

Type No.	Spectral response range λ (nm)	Peak sensitivity wavelength λ _p (nm)	Photo sensitivity S (A/W)			Infrared sensitivity ratio (%)	Short circuit current I _{sc} 100 lx (μA)	Temp. coefficient of I _{sc} (%/°C)	Dark current I _D V _R =1 V Max. (pA)	Temp. coefficient of I _D T _{CID} (times/°C)	Rise time t _r V _R =0 V R _L =1 kΩ (μs)	Terminal capacitance C _t V _R =0 V f=10 kHz (pF)	Shunt resistance R _{sh} V _R =10 mV	
			λ _p	GaP LED 560 nm	He-Ne laser 633 nm								Min. (GΩ)	Typ. (GΩ)
S1087	320 to 730	560	0.3	0.3	0.19	10	0.16	-0.01	10	1.12	200	10	250	
S1087-01	320 to 1100	960	0.58	0.33	0.38	-	1.3	0.1						
S1133	320 to 730	560	0.3	0.3	0.19	10	0.65	-0.01						
S1133-01	320 to 1100	960	0.58	0.33	0.38	-	5.6	0.1						
S1133-14	320 to 1000	720	0.4		0.37	-	3.4							

■ Spectral response

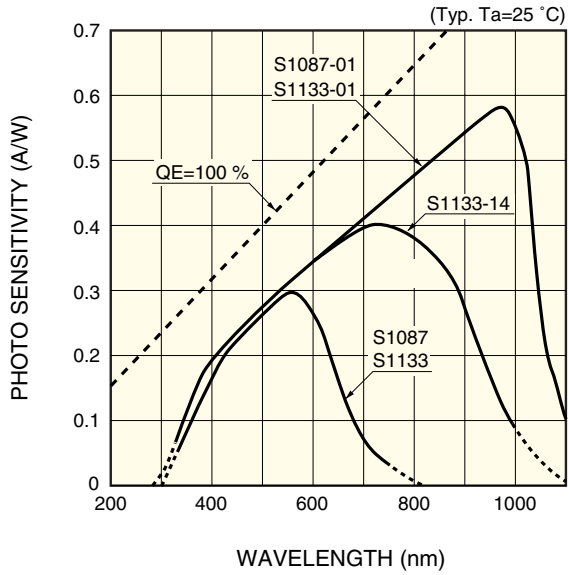

KSPDB0119EA

■ Photo sensitivity temperature characteristic (typical example: S1087)

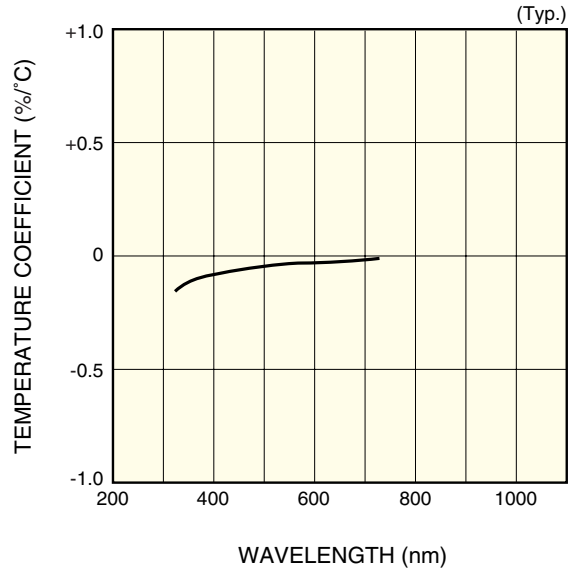

KSPDB0063EB

■ Rise time vs. load resistance

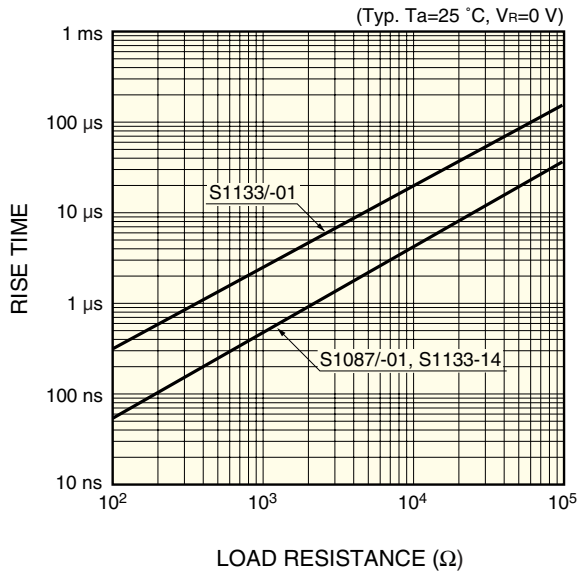

KSPDB0120EA

■ Dark current vs. reverse voltage

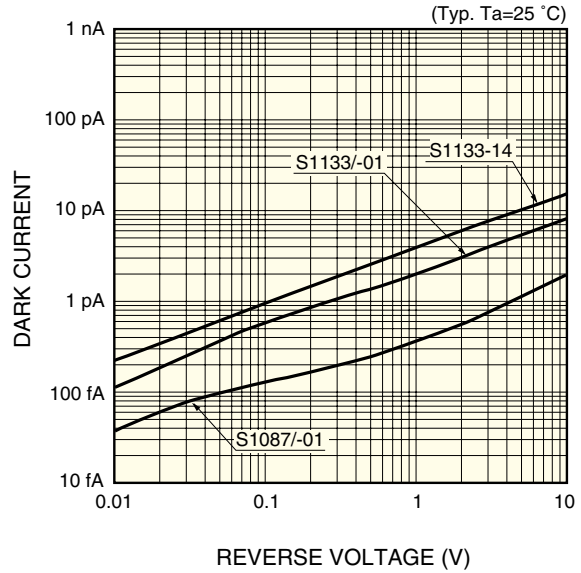

KSPDB0121EA

■ Shunt resistance temperature characteristics

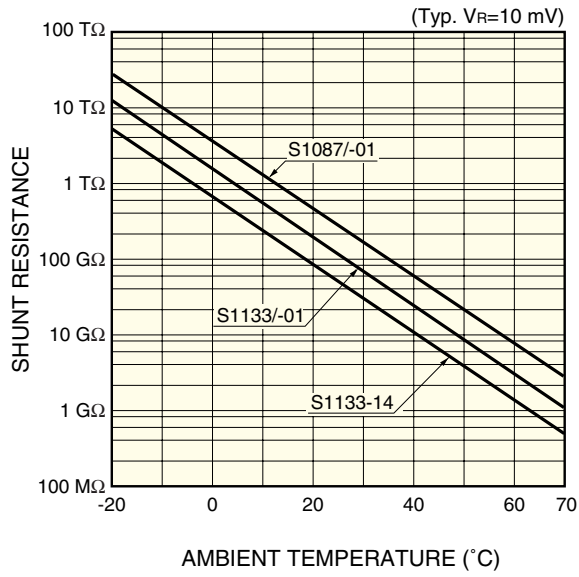

KSPDB0122EA

■ Short circuit current linearity

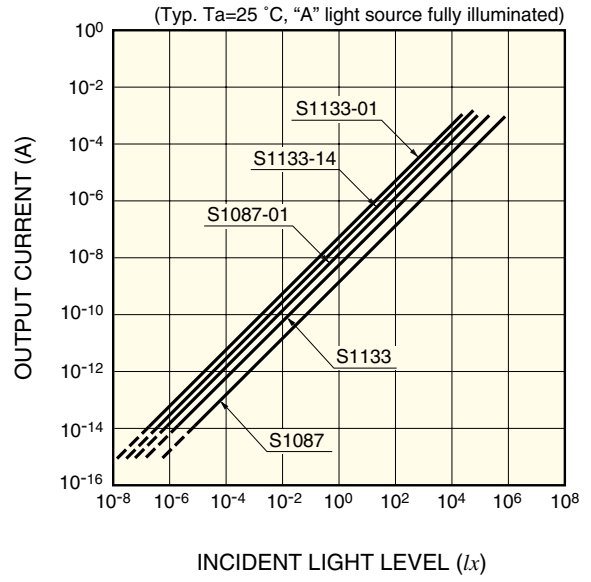

KSPDB0123EA

■ Dimensional outlines (unit: mm, tolerance unless otherwise noted: ± 0.15)

① S1087

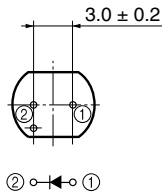
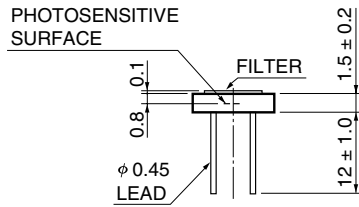
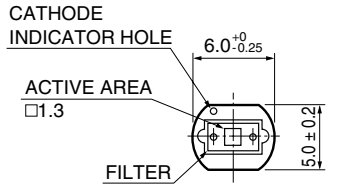

KSPDA0053EA

② S1087-01

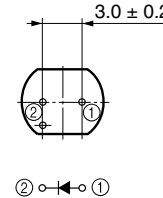
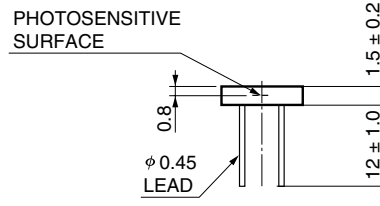
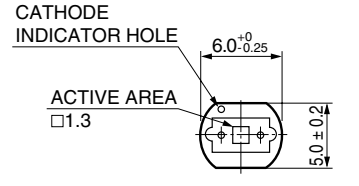

KSPDA0052EA

③ S1133

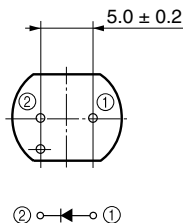
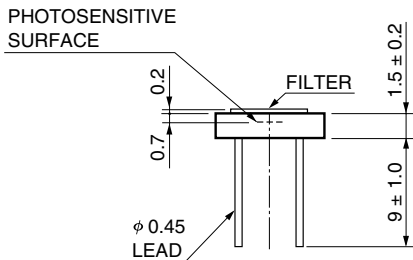
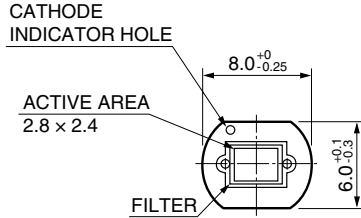

KSPDA0055EA

④ S1133-01/-14

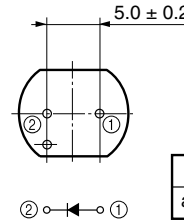
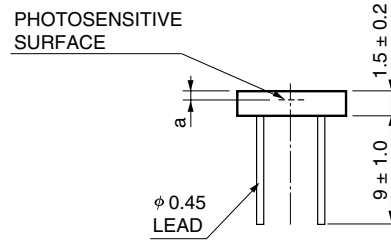
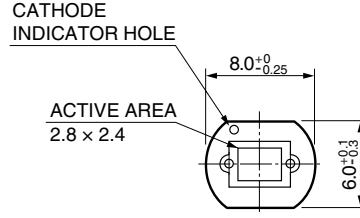

	S1133-01	S1133-14
a	0.7	0.6

KSPDA0054EA

HAMAMATSU

Information furnished by HAMAMATSU is believed to be reliable. However, no responsibility is assumed for possible inaccuracies or omissions. Specifications are subject to change without notice. No patent rights are granted to any of the circuits described herein. ©2001 Hamamatsu Photonics K.K.

HAMAMATSU PHOTONICS K.K., Solid State Division

1126-1 Ichino-cho, Hamamatsu City, 435-8558 Japan, Telephone: (81) 053-434-3311, Fax: (81) 053-434-5184, <http://www.hamamatsu.com>

U.S.A.: Hamamatsu Corporation, 360 Foothill Road, P.O.Box 6910, Bridgewater, N.J. 08807-0910, U.S.A., Telephone: (1) 908-231-0960, Fax: (1) 908-231-1218

Germany: Hamamatsu Photonics Deutschland GmbH: Arzbergerstr. 10, D-82211 Herrsching am Ammersee, Germany, Telephone: (49) 08152-3750, Fax: (49) 08152-2658

France: Hamamatsu Photonics France S.A.R.L.: 8, Rue du Saule Trapu, Parc du Moulin de Massy, 91882 Massy Cedex, France, Telephone: 33-(1) 69 53 71 00, Fax: 33-(1) 69 53 71 10

United Kingdom: Hamamatsu Photonics UK Limited: 2 Howard Court, 10 Tewin Road, Welwyn Garden City, Hertfordshire AL7 1BW, United Kingdom, Telephone: (44) 1707-294888, Fax: (44) 1707-325777

North Europe: Hamamatsu Photonics Norden AB: Smidsvägen 12, SE-171 41 Solna, Sweden, Telephone: (46) 8-509-031-00, Fax: (46) 8-509-031-01

Italy: Hamamatsu Photonics Italia S.R.L.: Strada della Moia, 1/E, 20020 Arese, (Milano), Italy, Telephone: (39) 02-935-81-733, Fax: (39) 02-935-81-741