

THIS DRAWING IS UNPUBLISHED. RELEASED FOR PUBLICATION
 © COPYRIGHT 19 BY AMP INCORPORATED. ALL INTERNATIONAL RIGHTS RESERVED.

LOC	DIST	P	F	ZONE	LTR	DESCRIPTION	DATE	APPD
AJ	16				C	OBS -1 PER 0E10-0116-99	04FEB00	MO

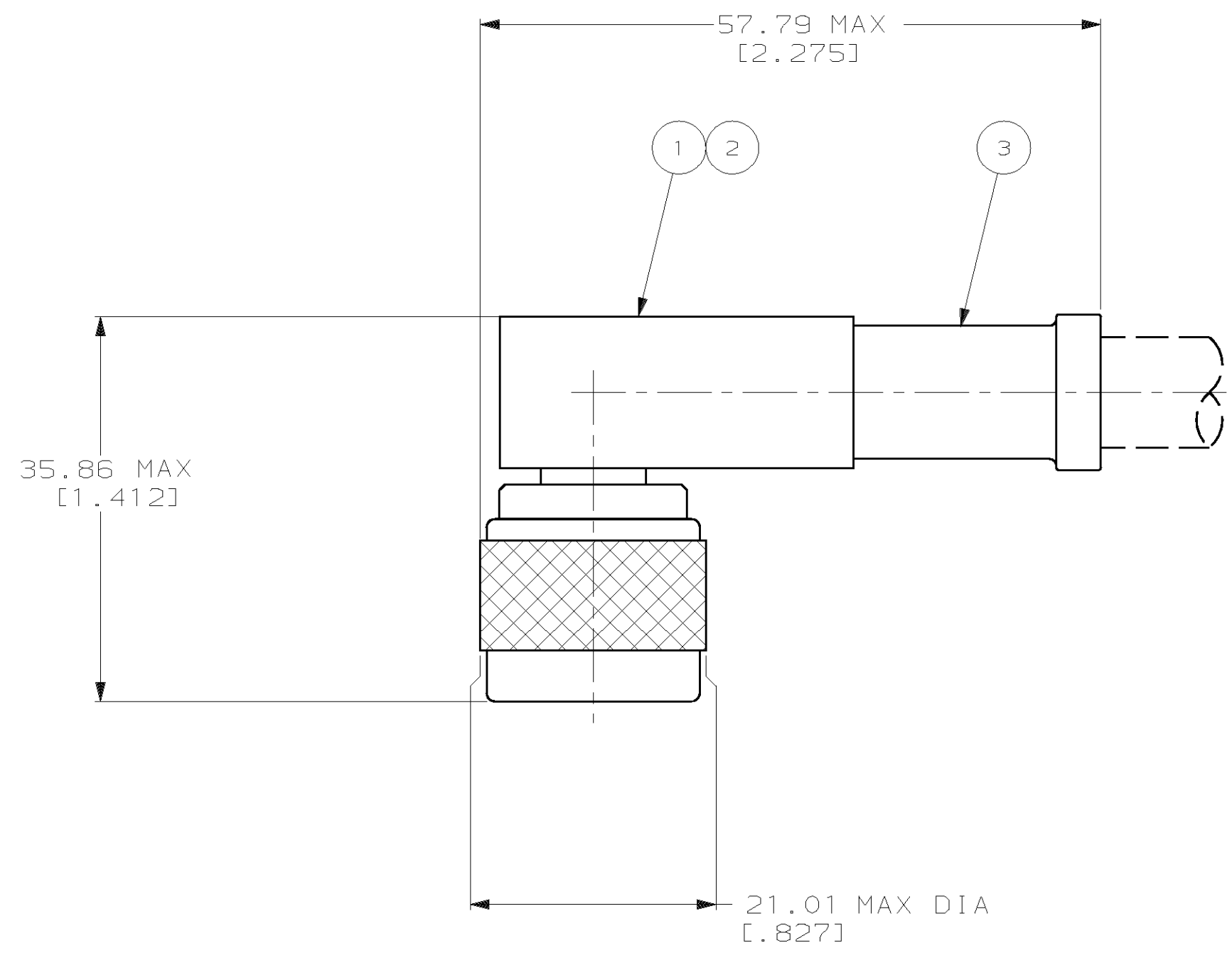

1. USE CRIMPING TOOL 220045-2
2. SEE I S 2028-5

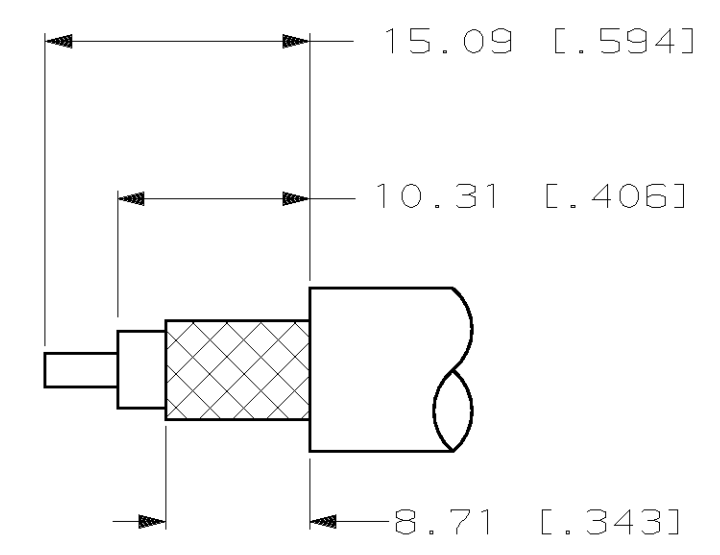

RECOMMENDED STRIP LENGTH

OBSOLETE	225394-5 & AMP	RG-141/U & BELDEN YR-20621	225560-2	225106-3	225414-2	225394-5
	225394-4 & AMP	RG-58A/U & 58C/U	225560-2	225106-1	225414-2	225394-4
OBSOLETE	10688588 & AMP	RG-55A/U & 223/U	225413-1	225106-1	225414-3	225394-3
	225394-2 & AMP	RG-142B/U	225560-1	225106-3	225414-1	225394-2
OBSOLETE	225394-1 & AMP	RG-55/U & 223/U	225560-1	225106-1	225414-1	225394-1
	STAMPING	CABLE	③ FERRULE QTY=1	② CONTACT QTY=1	① PLUG ASSY QTY=1	PART NUMBER

DO NOT SCALE PRINT. UNLESS SPECIFIED DIMENSIONS IN mm [INCHES] TOLERANCES ON : 2 PLC DEC ± 0.41 [.016] 3 PLC DEC ± - ANGLES ± -		DR 3-1-91 M. SNEED CHK 3-1-91 R. HENRY APPD 3-1-91 R. HENRY APPD 3-1-91 M. SNEED		AMP AMP Incorporated Harrisburg, PA 17105-3608	
MATERIAL -	FINISH -	PRODUCT SPEC 108-12019	APPLICATION SPEC -	NAME	PLUG, RIGHT ANGLE, SERIES N
		SIZE C	CAGE CODE 00779	DRAWING NO	225394
		WEIGHT -	SCALE 4:1	SHEET	1 OF 1